

# HOBART

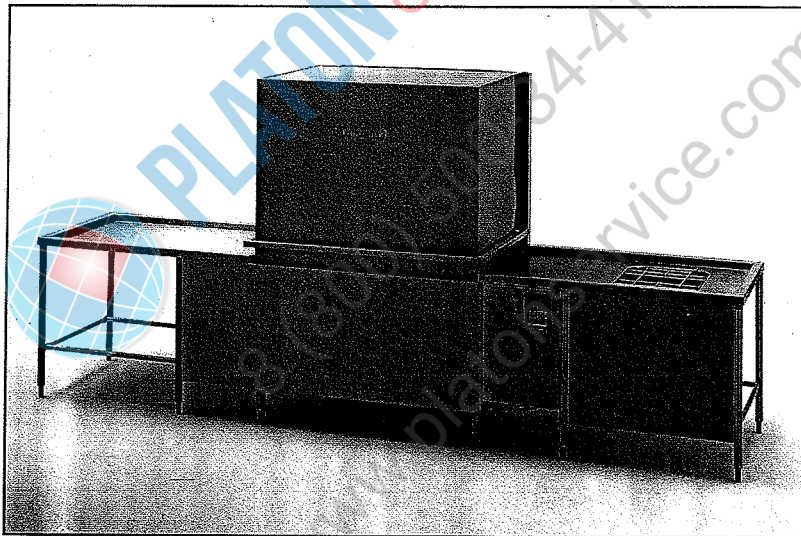

## UW-135/UW-135 H

**Spare Parts**  
**Pièces Détachées**  
**Ersatzteile**  
**Onderdelen**

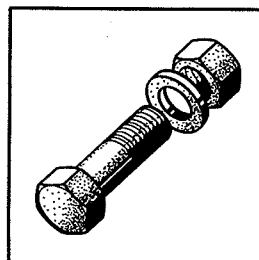

**Contents**

Frame and panels .....	4
Hood mechanic .....	5
Hood guide .....	6
Hood .....	7
Wash and rinse system .....	8
Strainers .....	9
Racks and track .....	10
Pump .....	11
Drain .....	12
Tank heating and float switch .....	13
Temperature and conductivity probe .....	14
Hydraulic cylinder .....	15
Fill and hood hydraulic pipework .....	16
Rinse booster heater, electric 9-18 kW .....	17
Rinse booster heater, steam or hot water .....	18
Pipework – steam, hot water .....	19
Control box .....	20
Table and scrapping system .....	21
Pipework – rinse pressure pump .....	22
Pipework – rinse pressure pump .....	23
Rinse agent dispenser .....	24
Detergent dispenser .....	25
Vacuum breaker .....	26
Splash guard .....	27

**Sommaire**

Chassis et panneaux .....	4
Mécanique caisson .....	5
Glissière de caisson .....	6
Caisson .....	7
Système de lavage et de rinçage .....	8
Filtres .....	9
Paniers et rails .....	10
Pompe .....	11
Vidange .....	12
Chauffage de bac et interrupteur à flotteur .....	13
Sondes de température et de conductivité .....	14
Cylindre hydraulique .....	15
Conduites de remplissage et d'hydraulique du caisson .....	16
Surchauffeur, électrique 9-18 kW .....	17
Surchauffeur, vapeur ou eau surchauffée .....	18
Conduite de vapeur, d'eau surchauffée .....	19
Coffret de commande .....	20
Table et système de pré lavage .....	21
Conduite de la pompe de rinçage .....	22
Conduite de la pompe de rinçage .....	23
Doseur de produit de rinçage .....	24
Doseur de produit tensio-activ .....	25
Brise-vide .....	26
Tôle anti-éclaboussure .....	27

**Inhalt**

Tankgestell und Verkleidungen .....	4
Haubenmechanik .....	5
Haubenführung .....	6
Haube .....	7
Waschsystem .....	8
Siebsystem .....	9
Körbe und Laufschienen .....	10
Pumpe .....	11
Ablauf .....	12
Tankheizung und Schwimmerschalter .....	13
Temperatur- und Leitwertfühler .....	14
Hydrozylinder .....	15
Fülleitung und Haubenhydraulik .....	16
Durchlauferhitzer, elektrisch 9-18 kW .....	17
Durchlauferhitzer, Dampf oder Heißwasser .....	18
Rohrleitungen Dampf, Heißwasser .....	19
Schaltkasten .....	20
Tisch- und Vorspülsystem .....	21
Rohrleitungen Drucksteigerungspumpe .....	22
Rohrleitungen Drucksteigerungspumpe .....	23
Klarspülmittel-Dosiergerät .....	24
Reinigungsmittel Dosiergerät .....	25
Rücksaugeverhinderer .....	26
Spritzblech .....	27

**Inhoud**

Tank en panelen .....	4
Kapmechanik .....	5
Kapgeleiding .....	6
Kap .....	7
Was en spoelsysteem .....	8
Zeeven .....	9
Rekken en rekken rails .....	10
Pomp .....	11
Afvoer .....	12
Tankverwarming en zwemschakelaar .....	13
Termometer en huls en geleidingsmeting .....	14
Hydraulische cylinder .....	15
Vulleiding en hoed hydraulic .....	16
Booster, elektrisch 9-18 kW .....	17
Booster, stoom of heet water .....	18
Waterpijp – stoom, heet water .....	19
Schakelkast .....	20
Tafel en voorspoelsysteem .....	21
Waterpijp voor spoeldrukomp .....	22
Waterpijp voor spoeldrukomp .....	23
Spoelmiddel-Doseerapparaat .....	24
Wasmiddel-doseerapparaat .....	25
Vacuumbreaker .....	26
Spat plaat .....	27

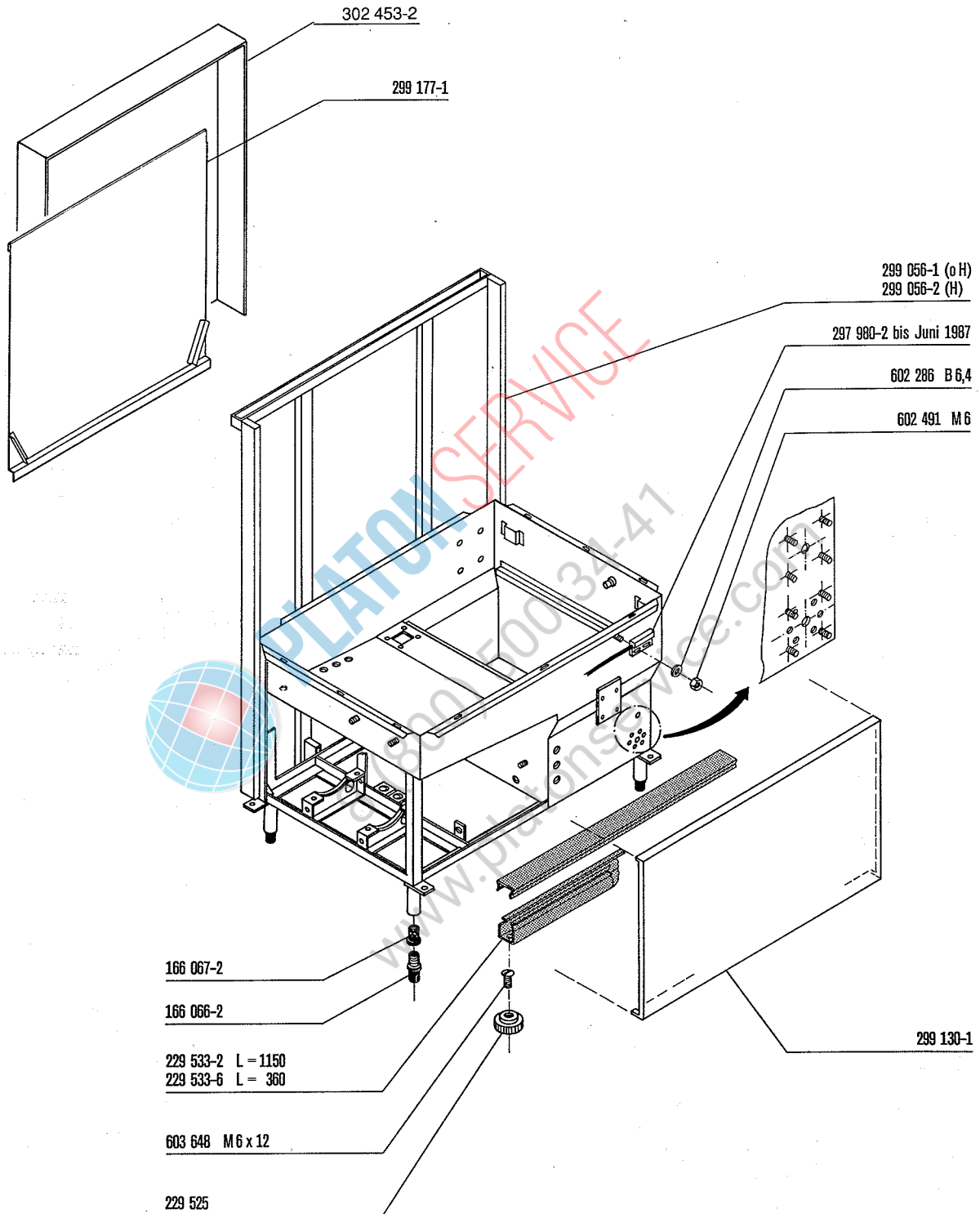

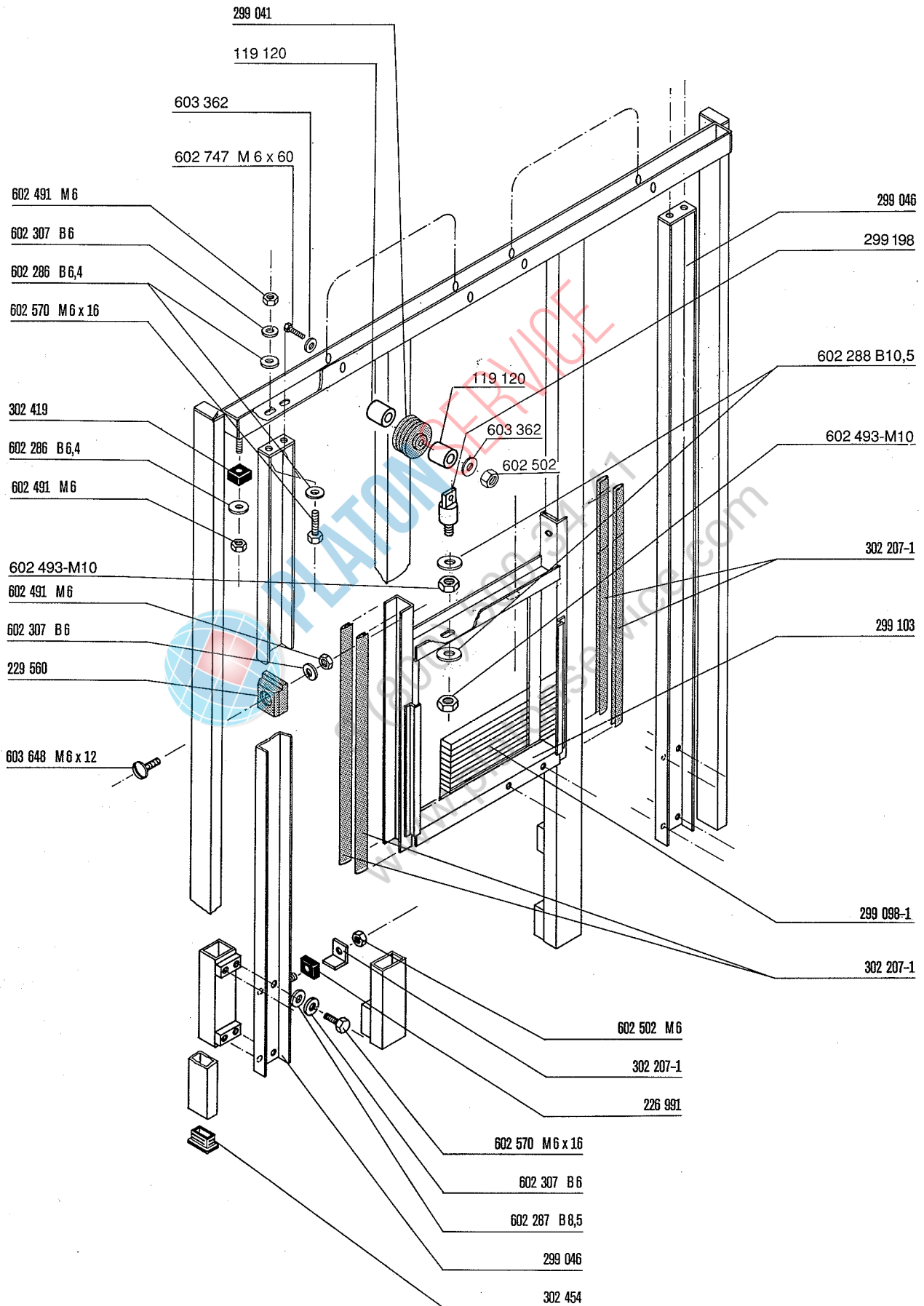

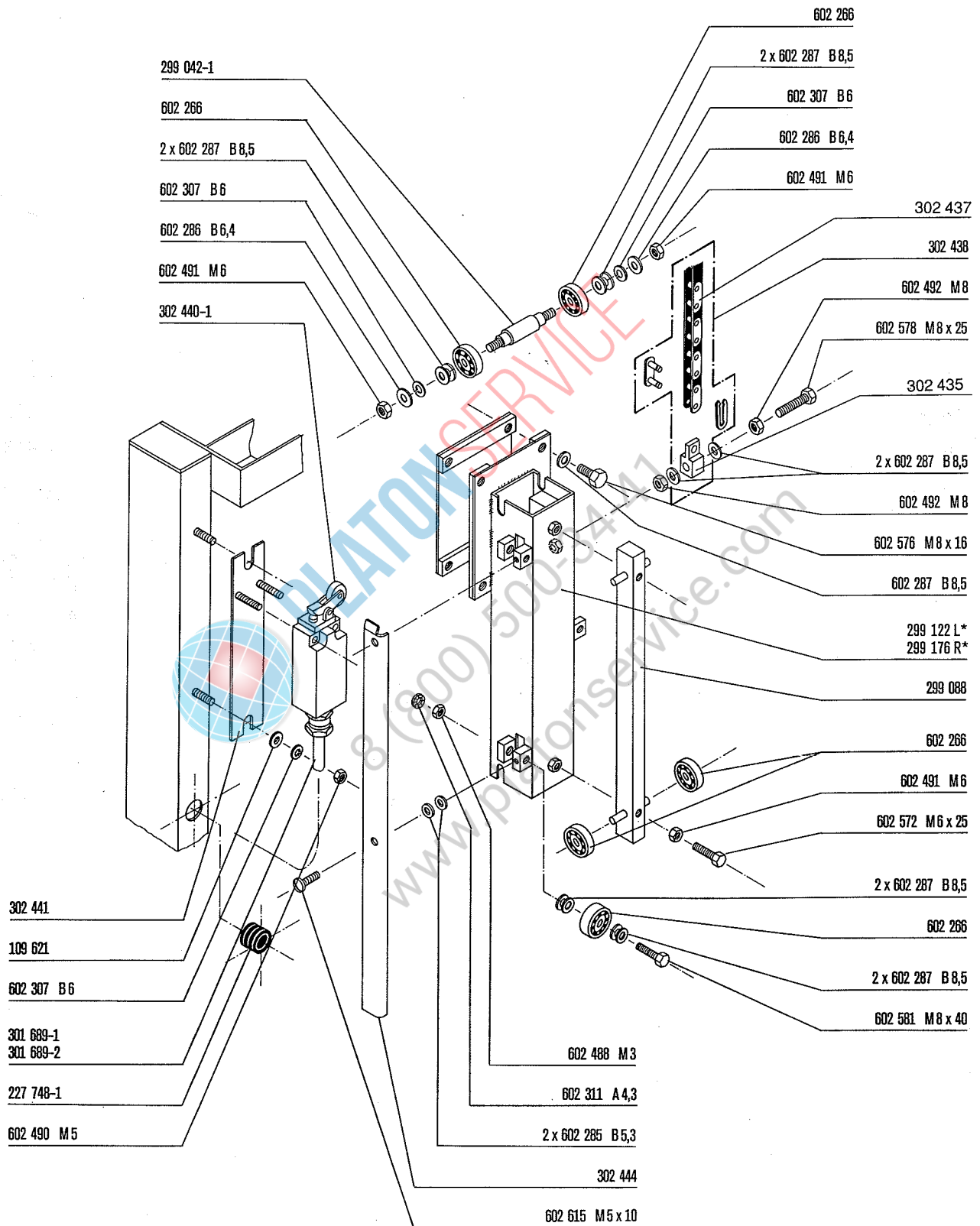

\*L = left  
 gauche  
 links  
 links

\*R = right  
 droite  
 rechts  
 rechts

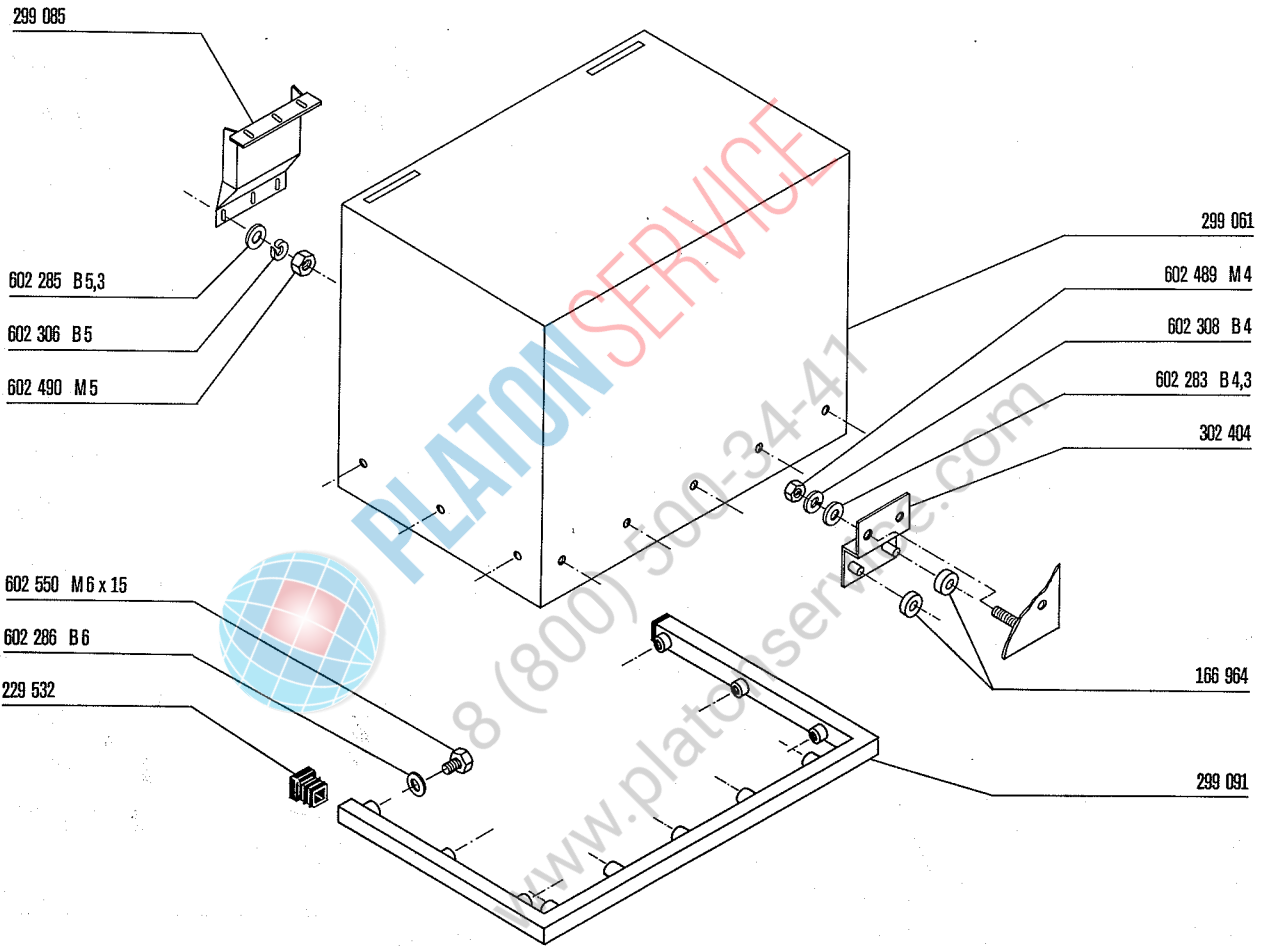

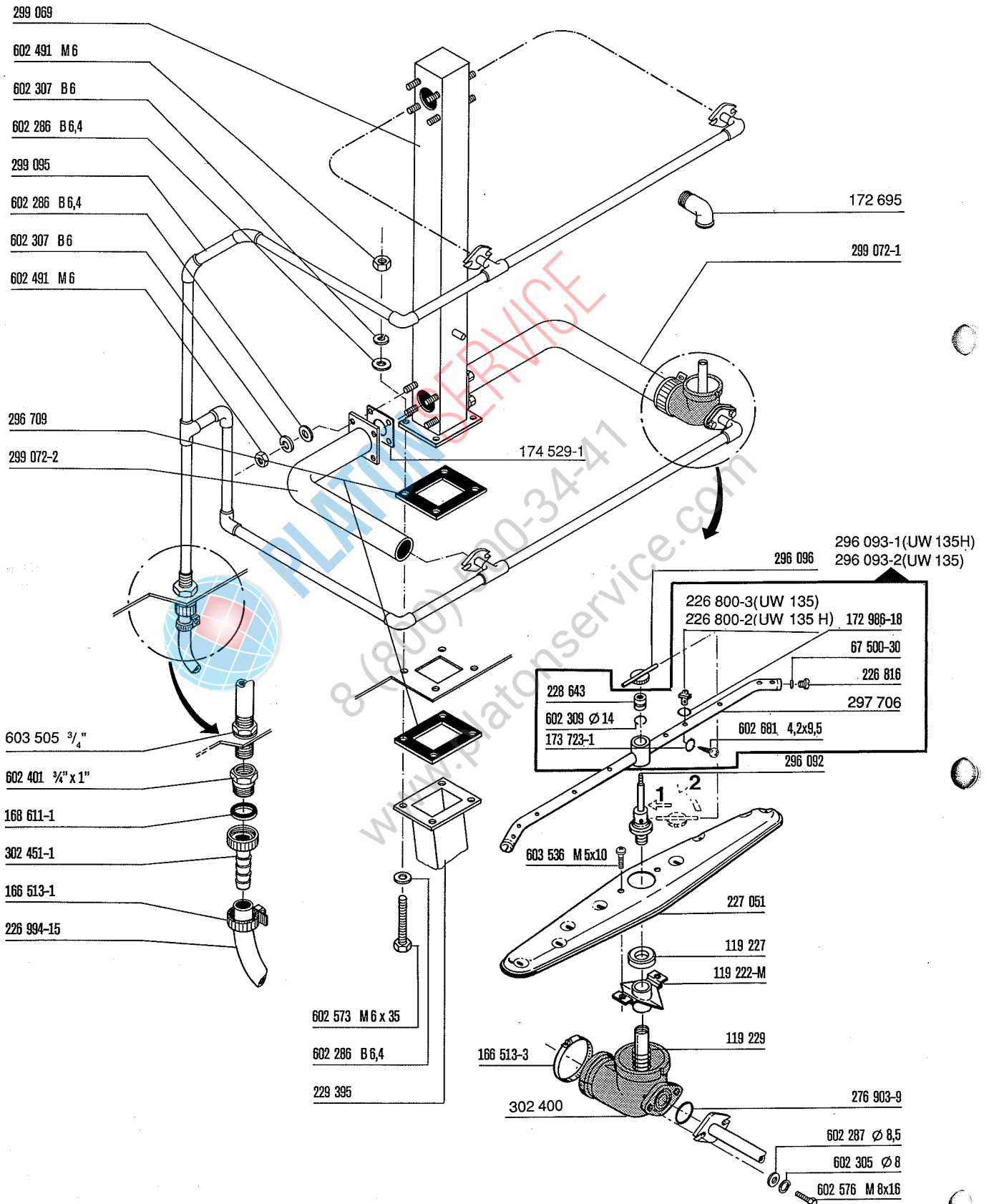

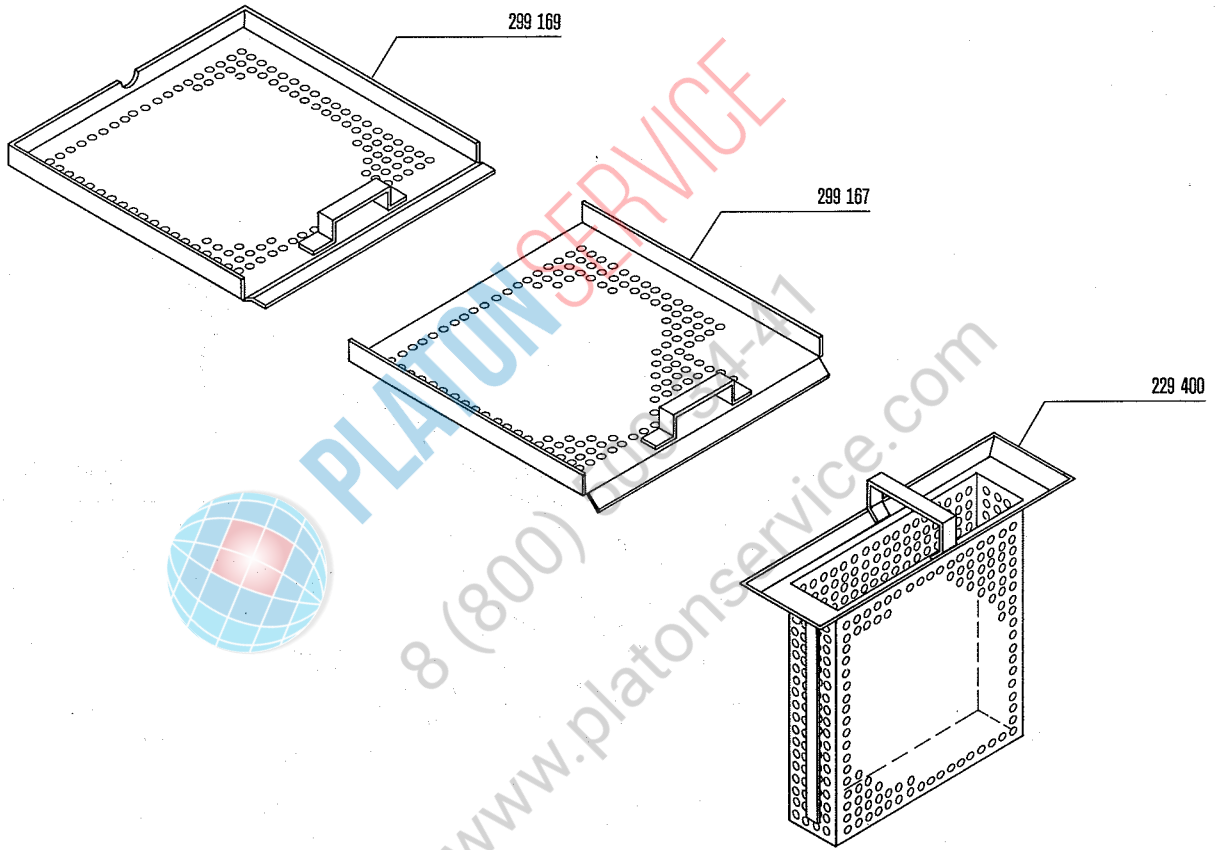



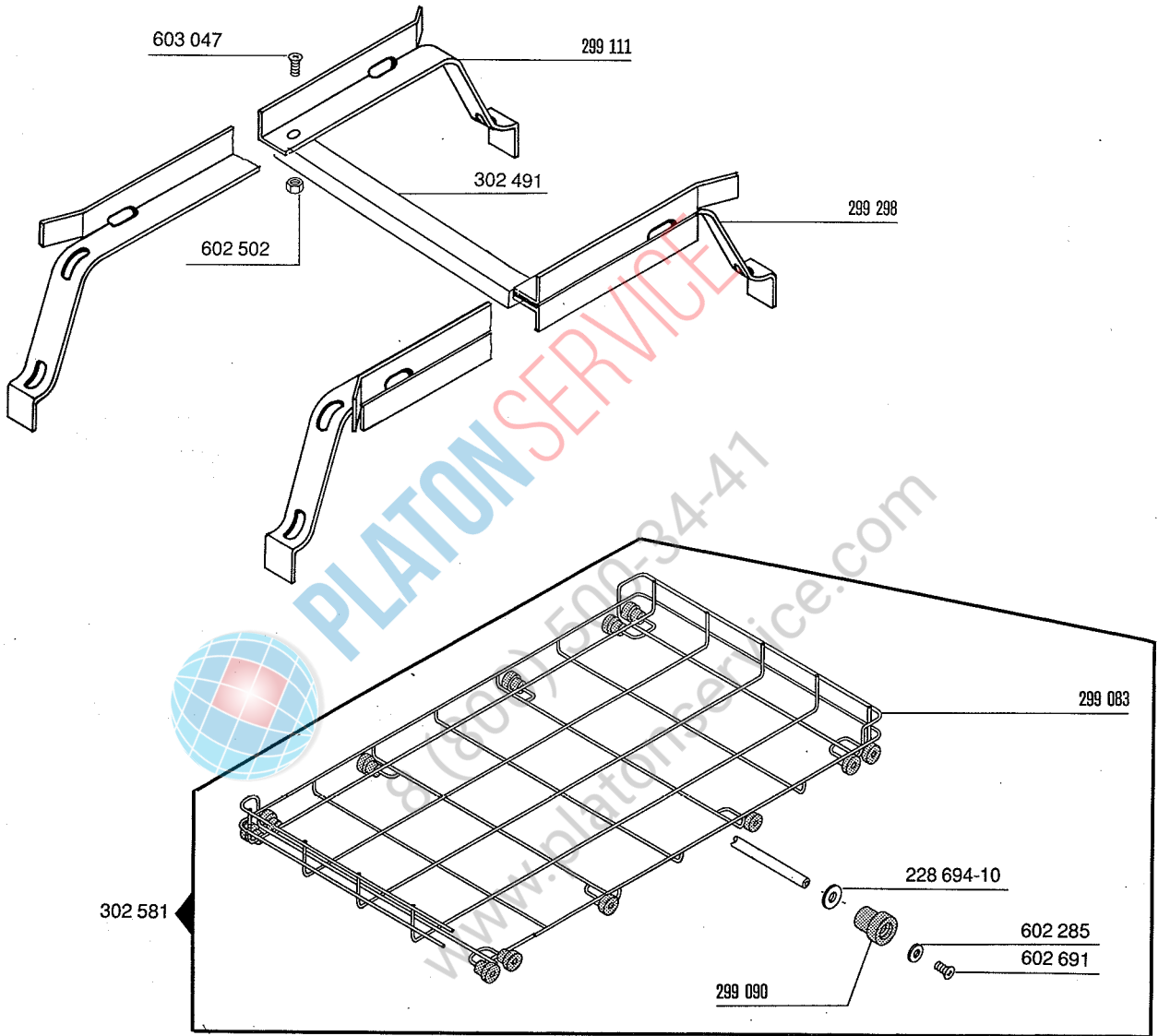

172 829

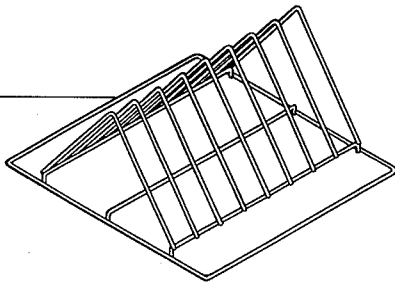

172 830-3

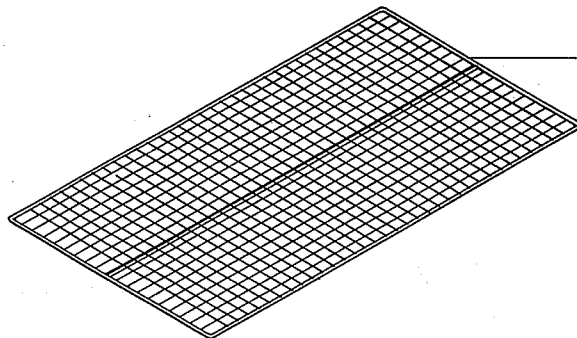

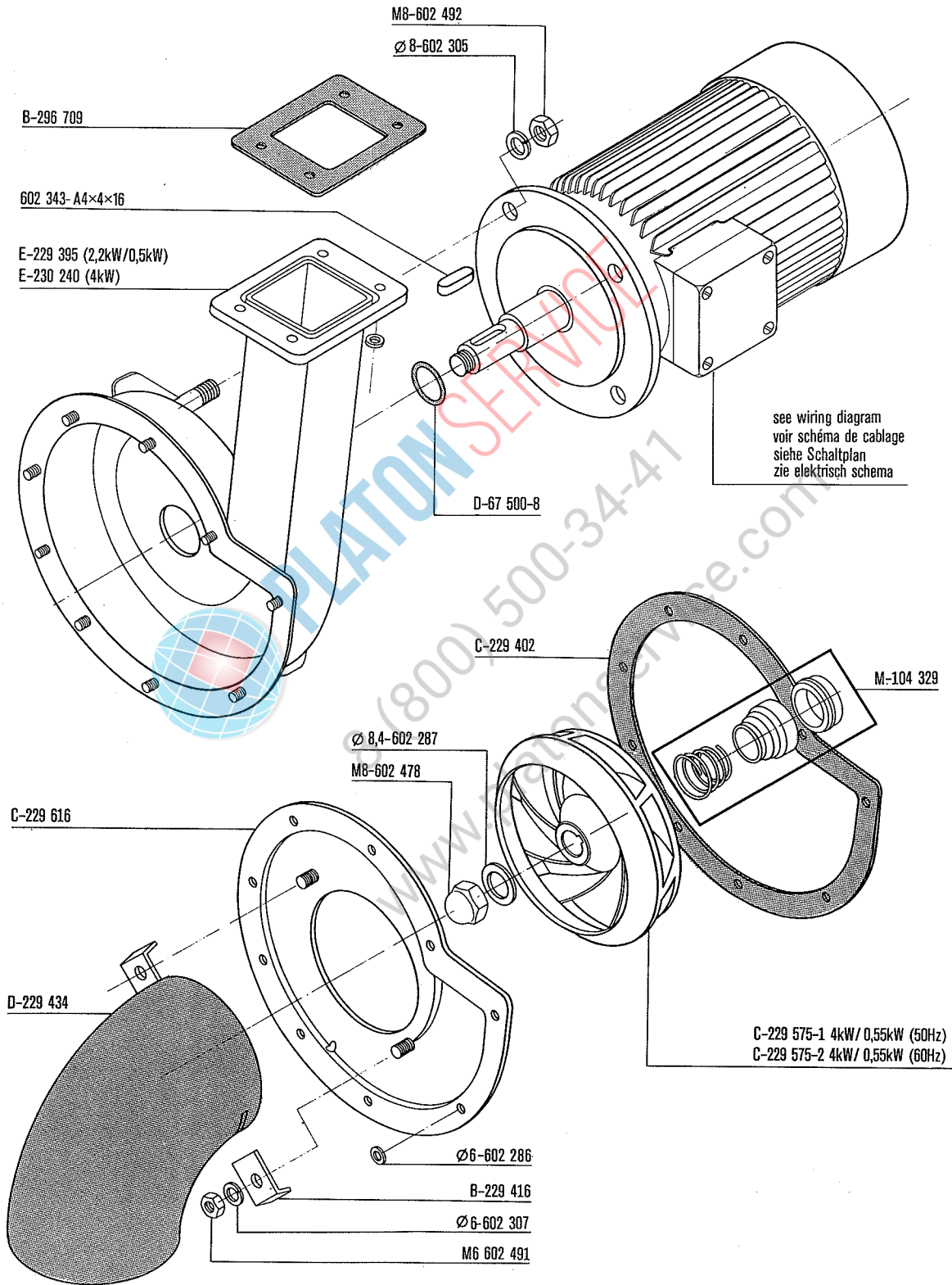

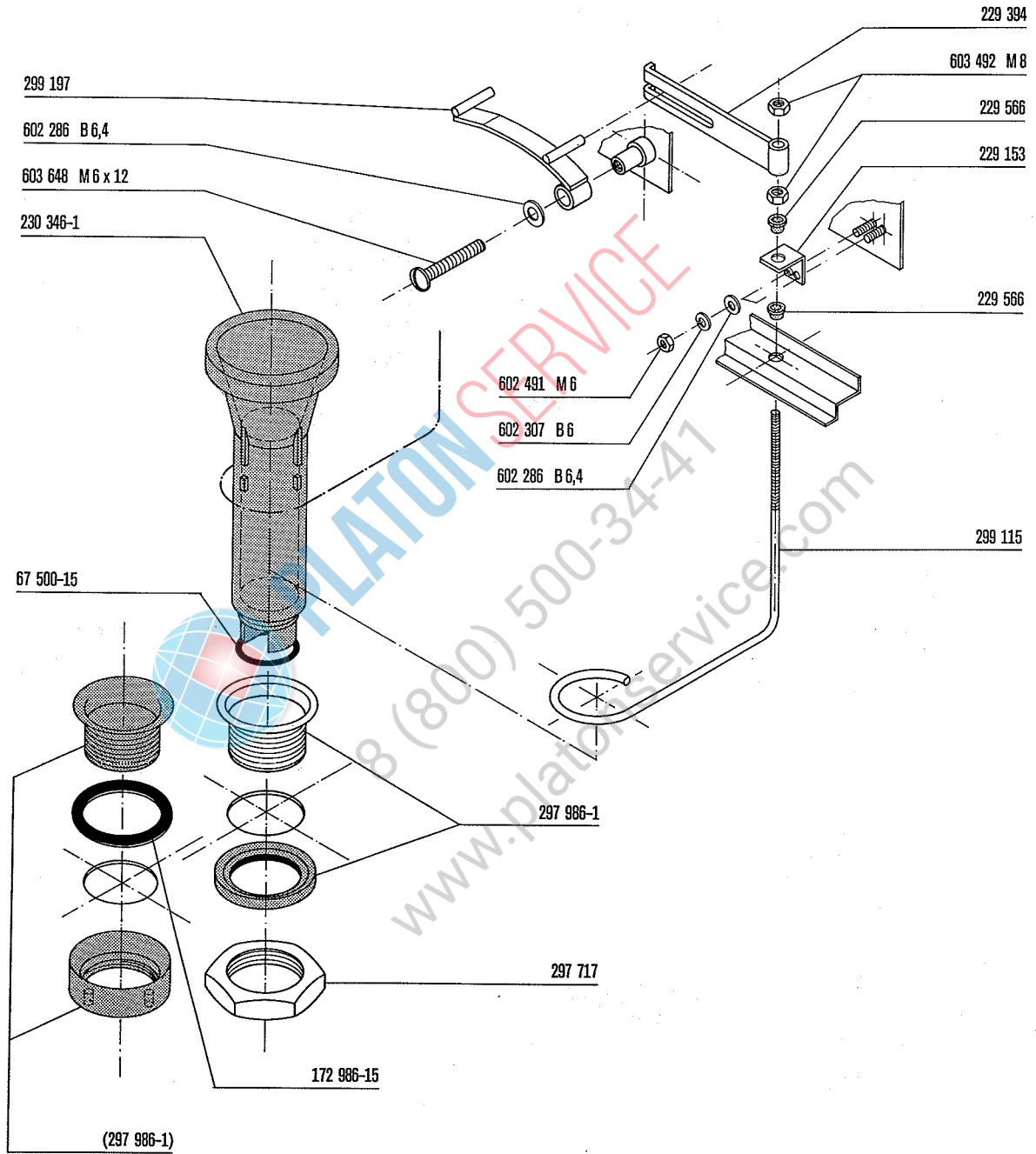

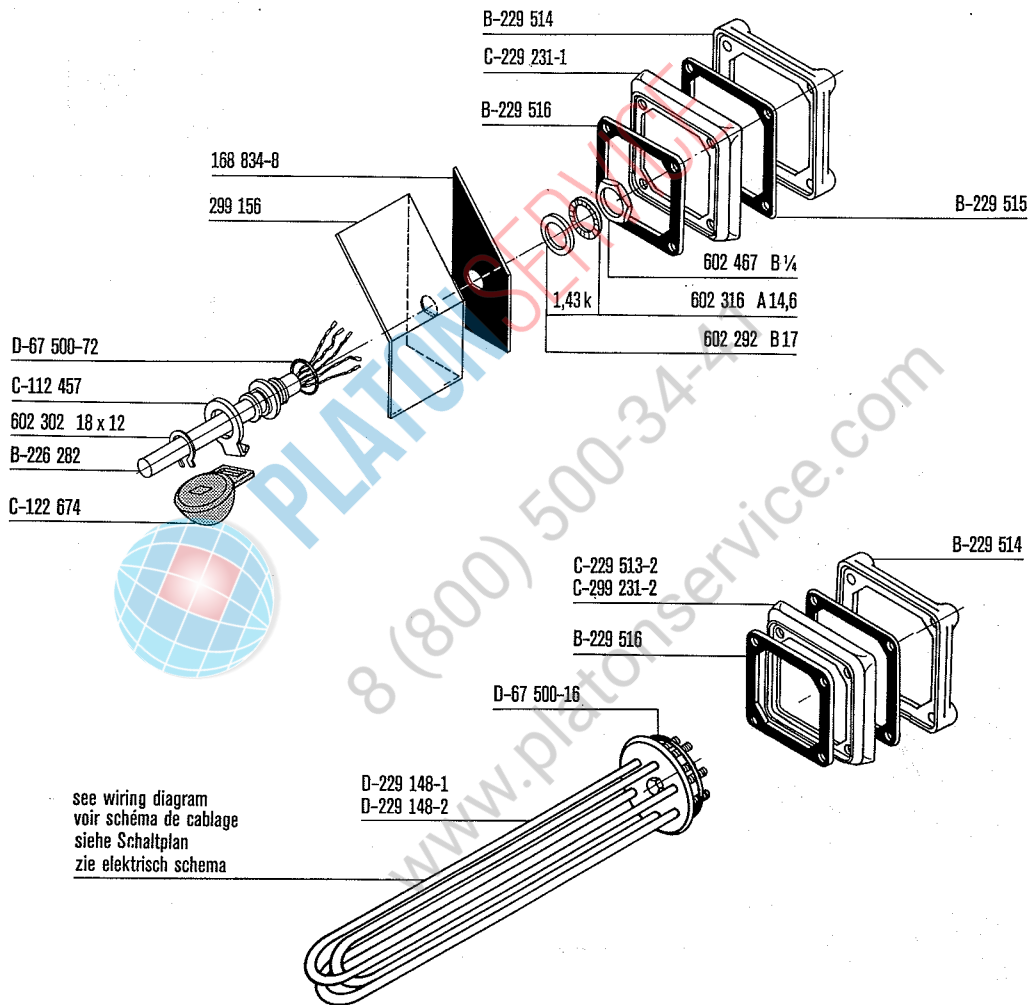

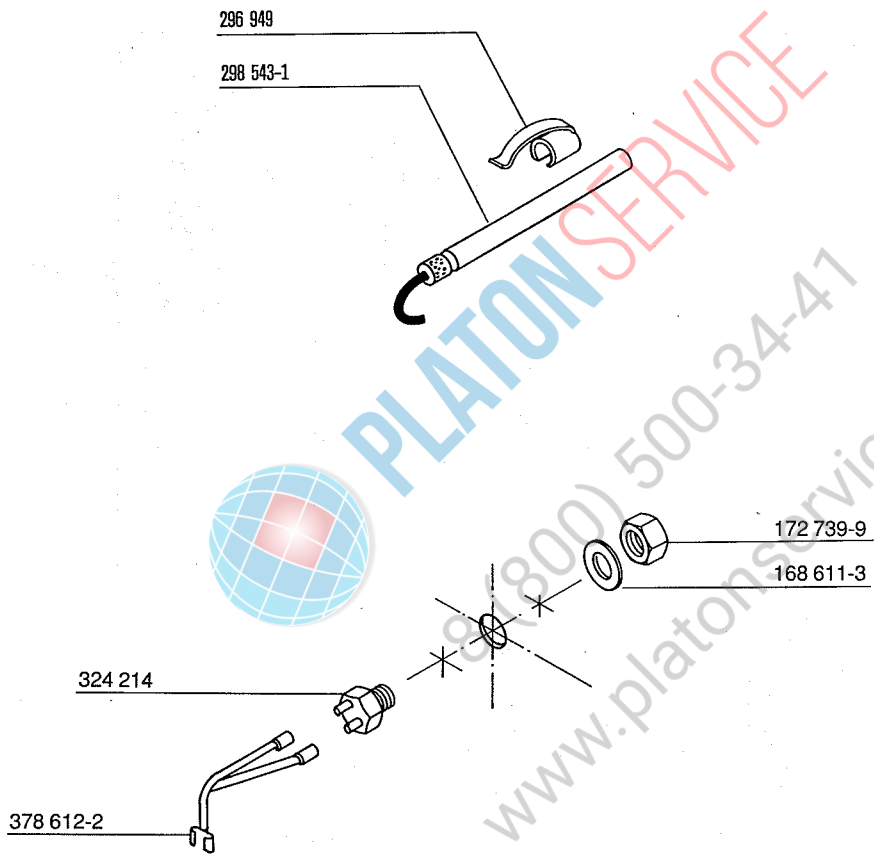

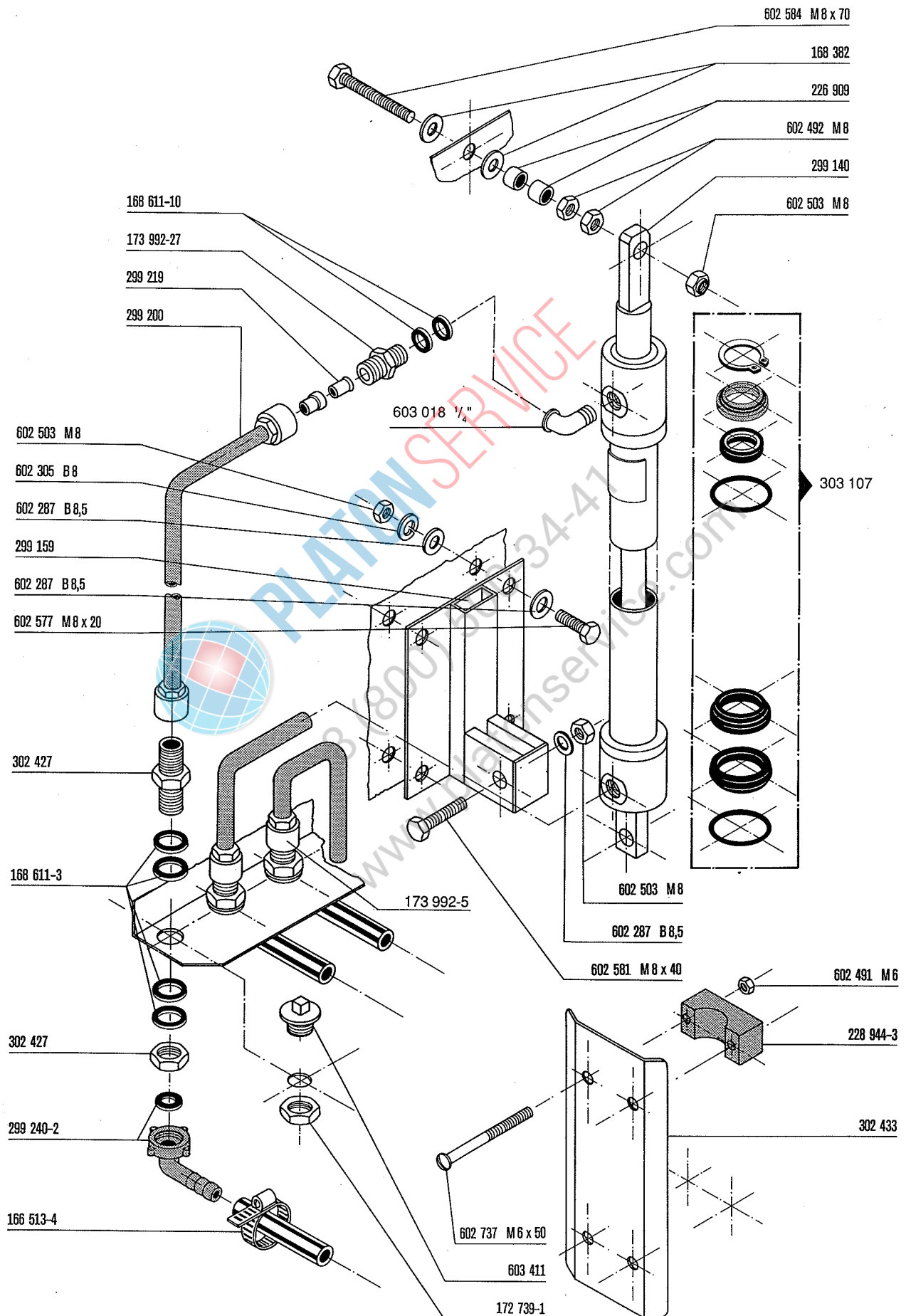

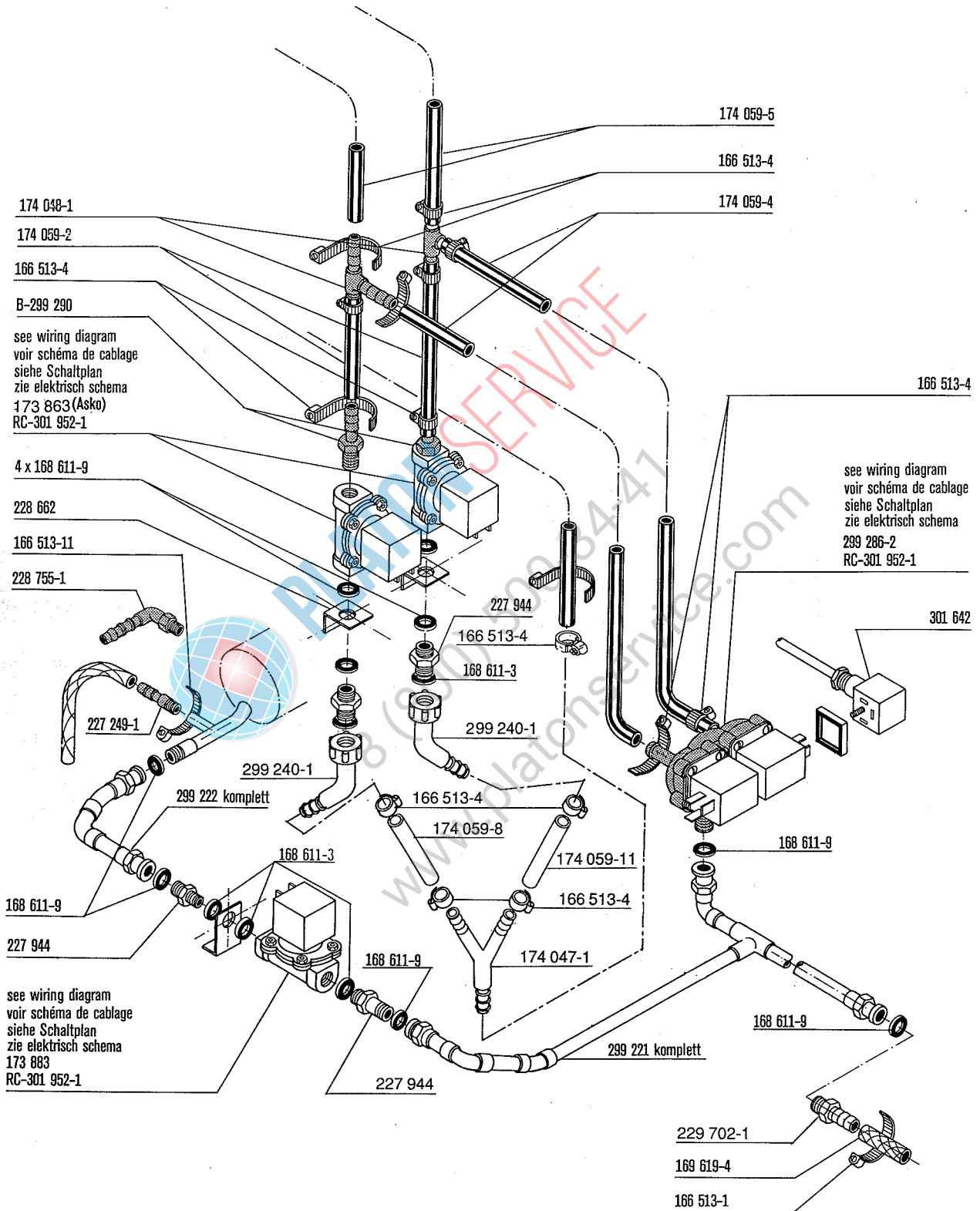

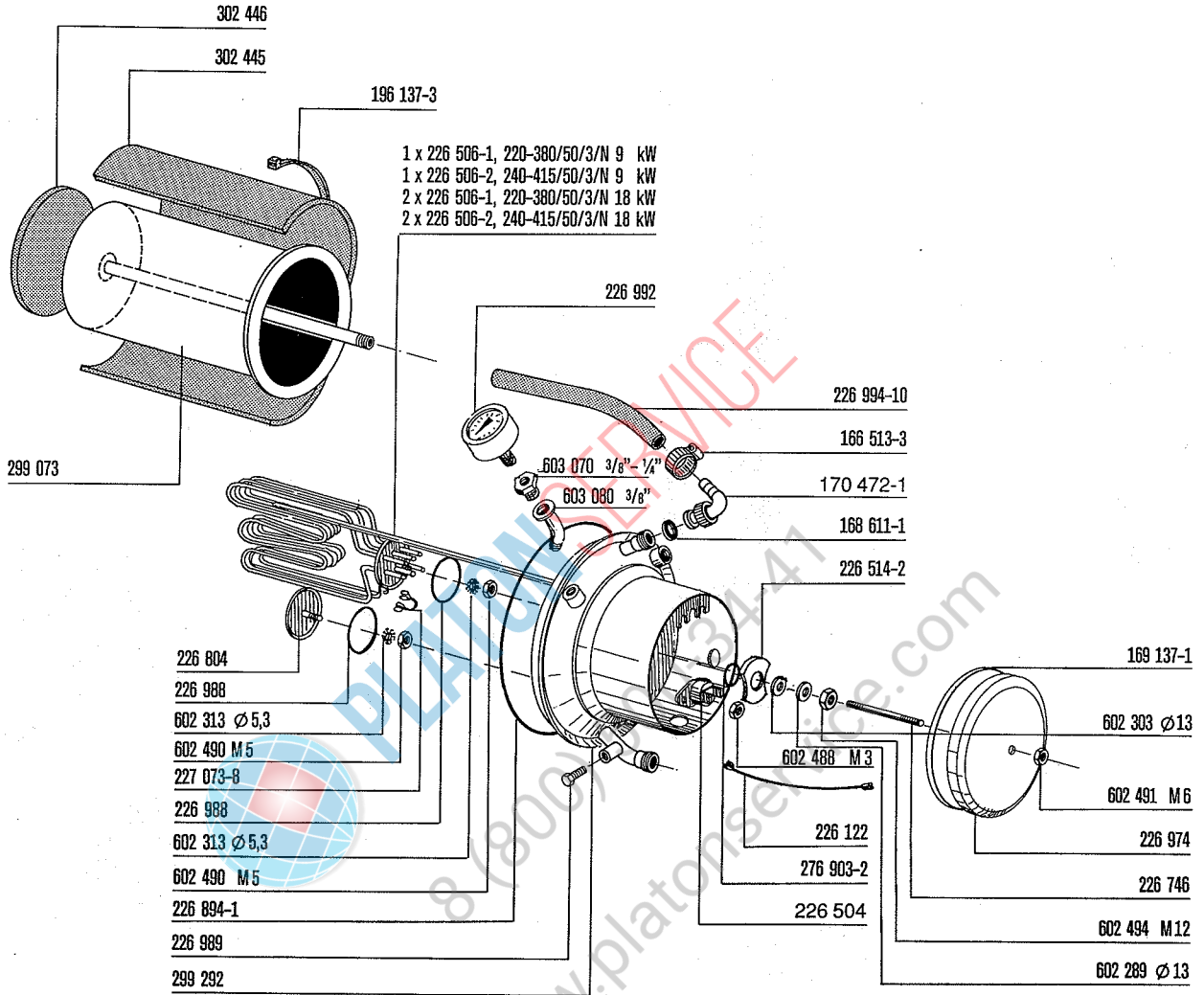



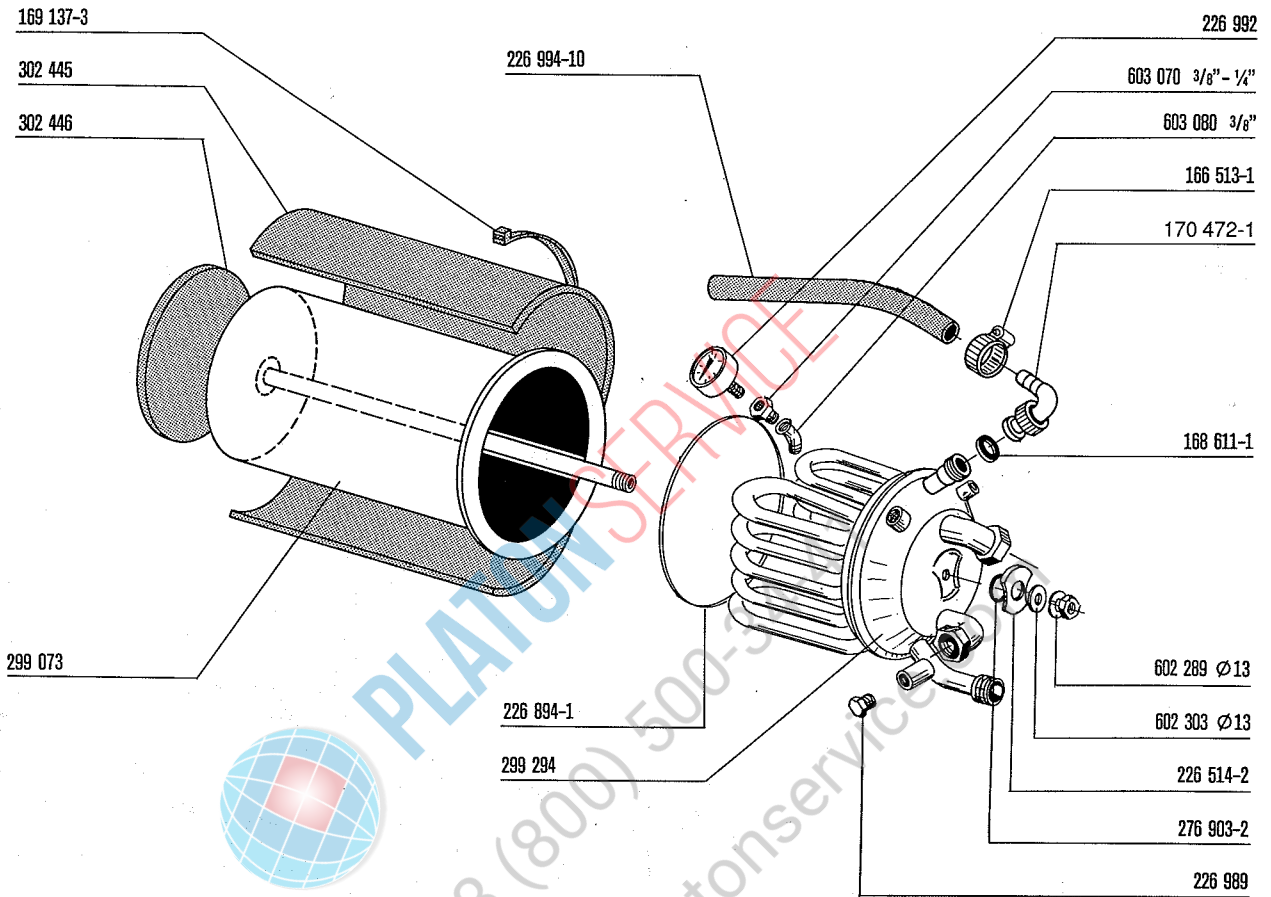

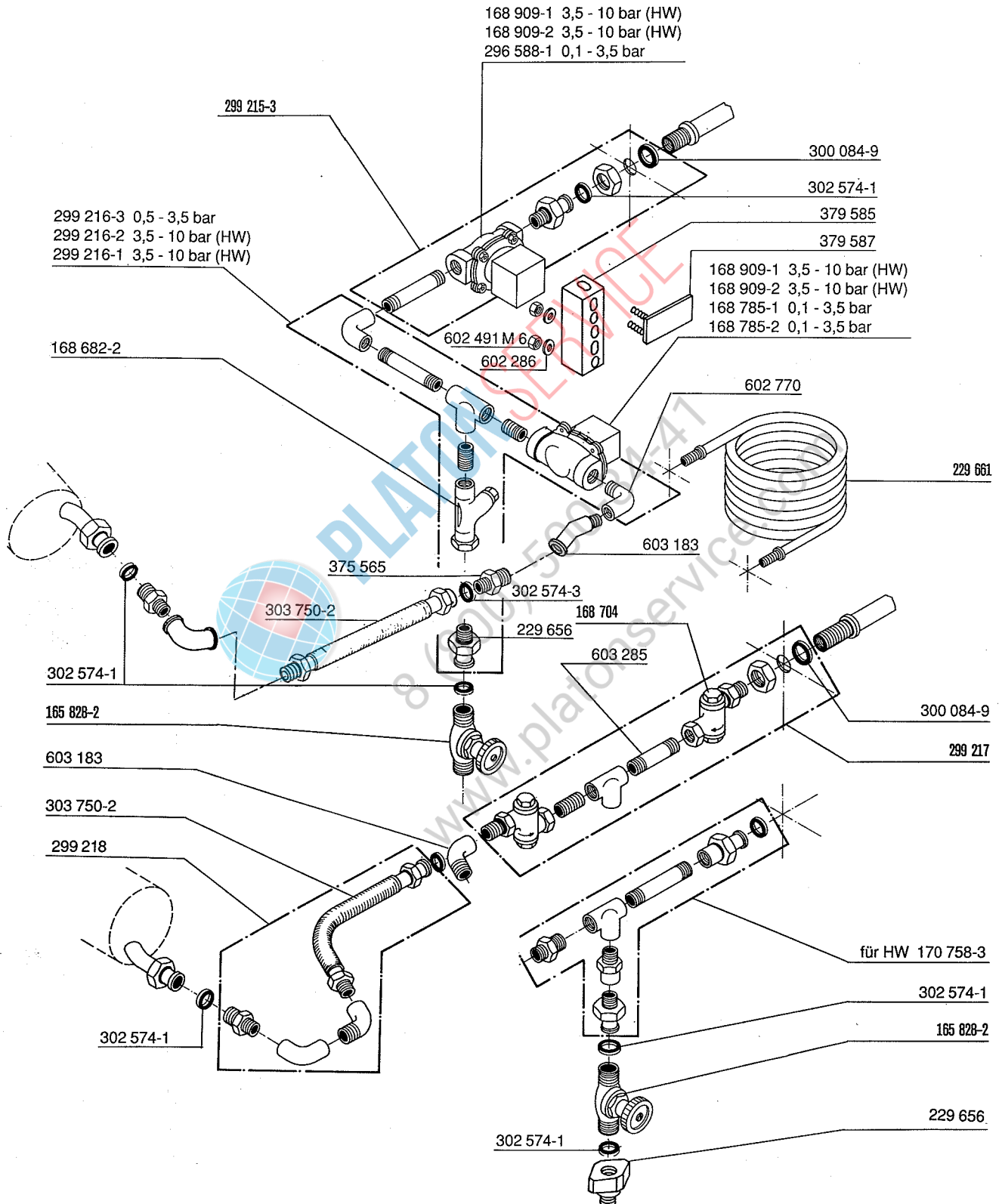

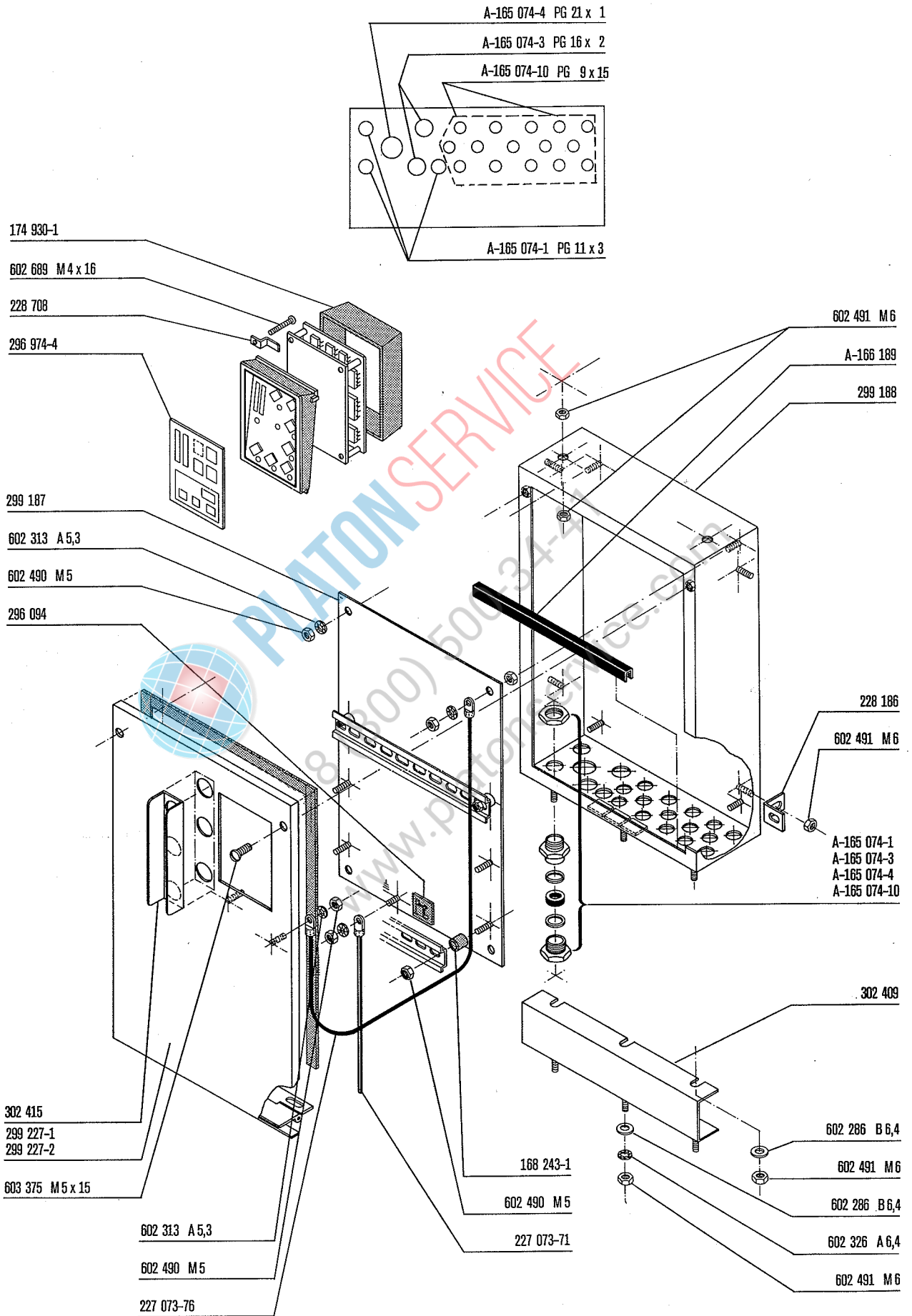

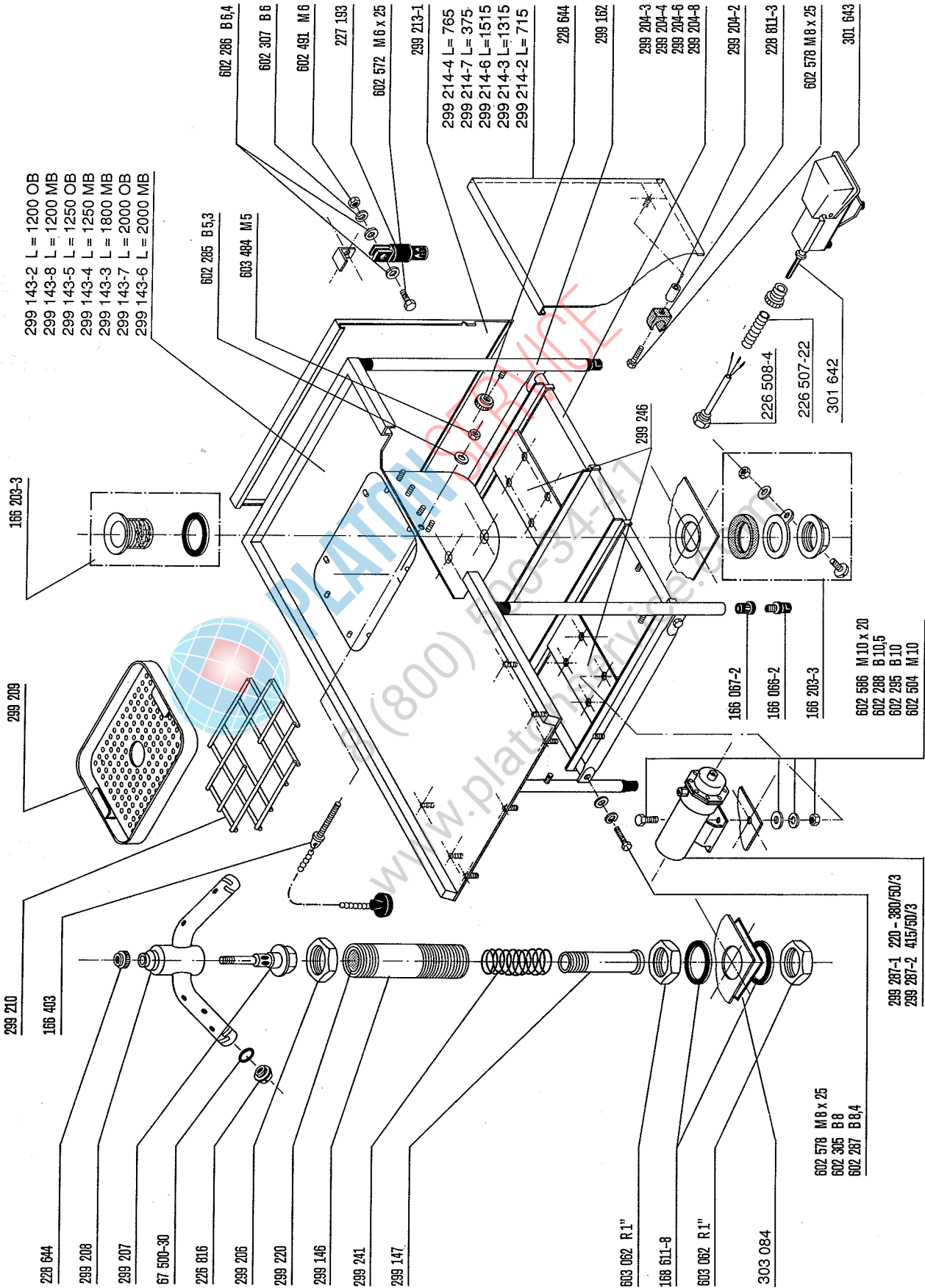

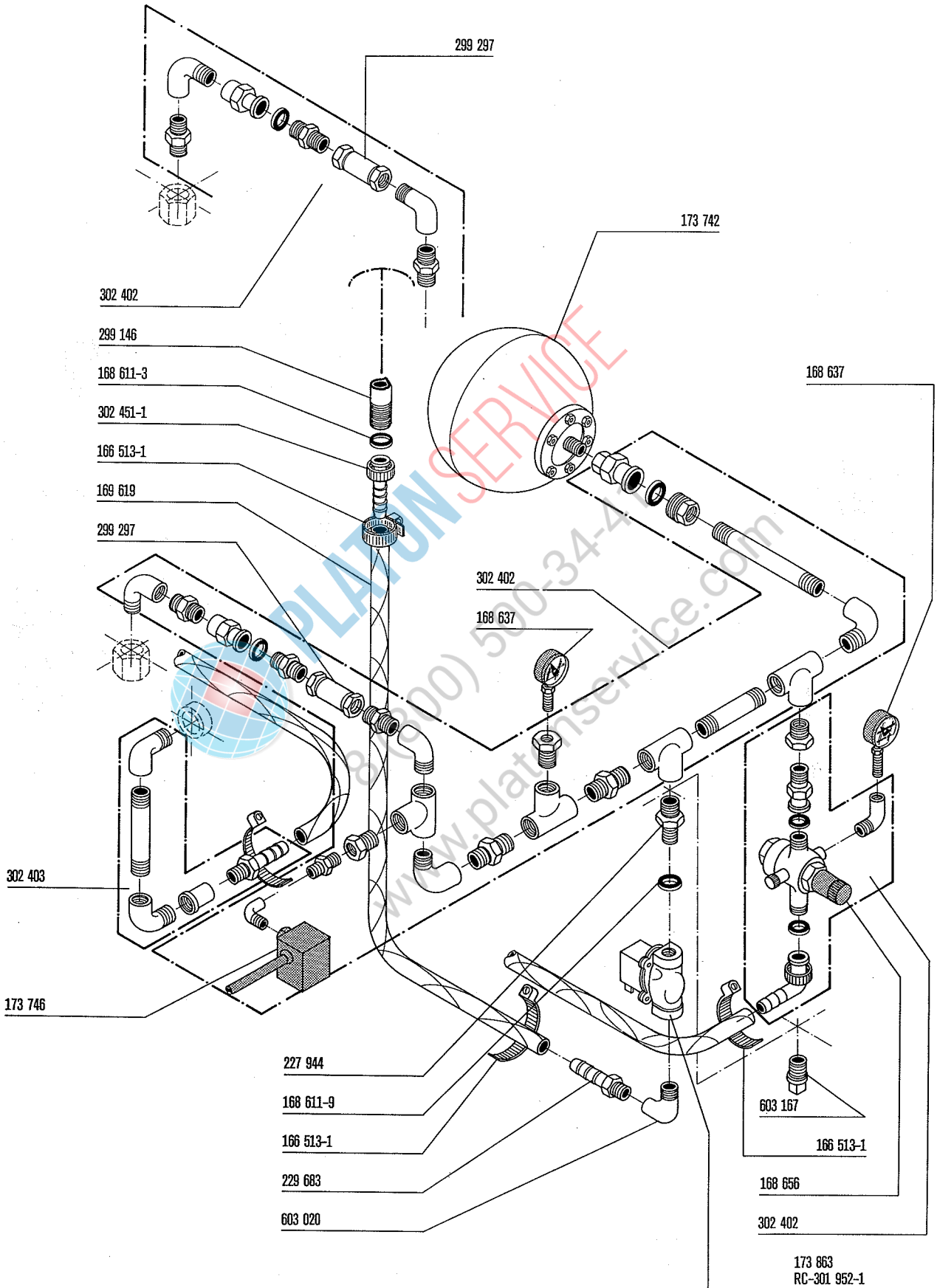

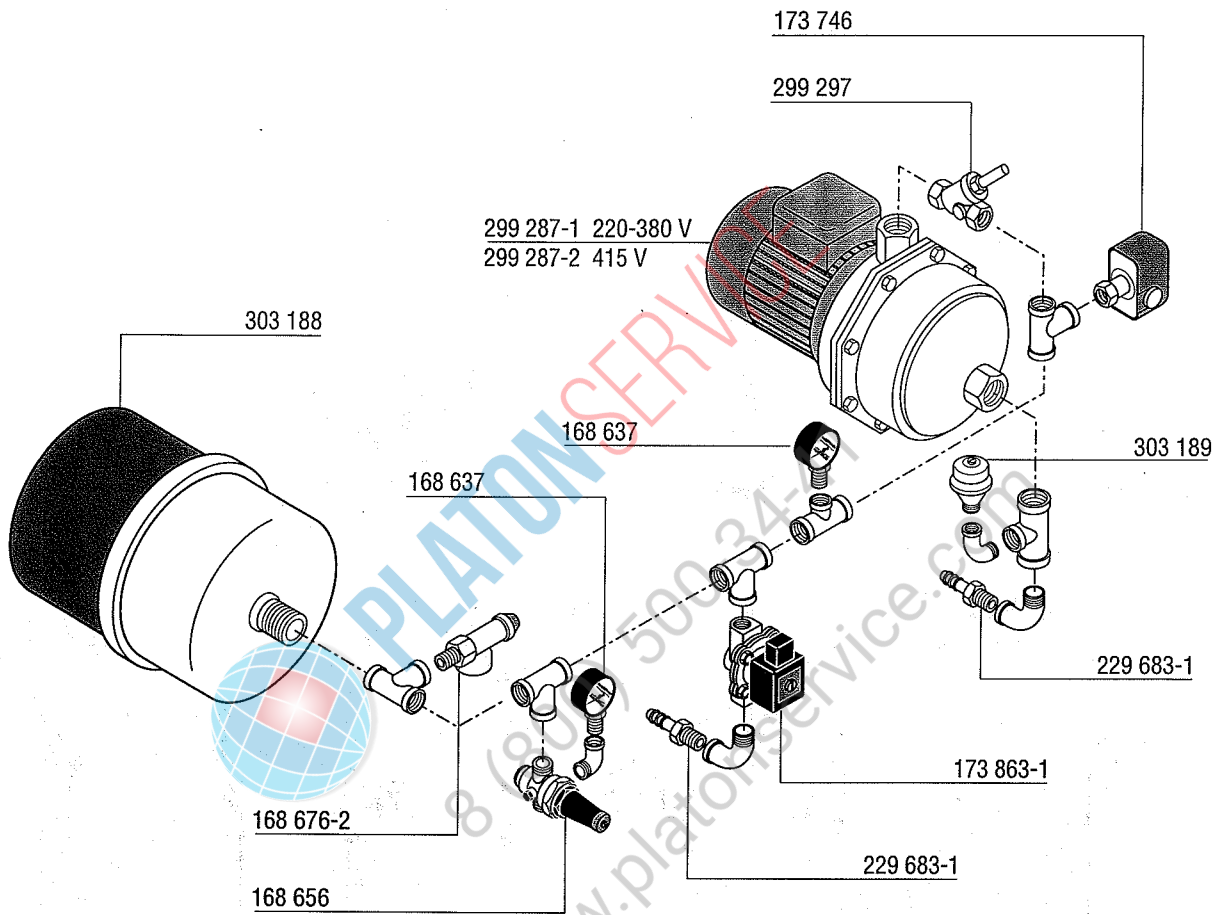

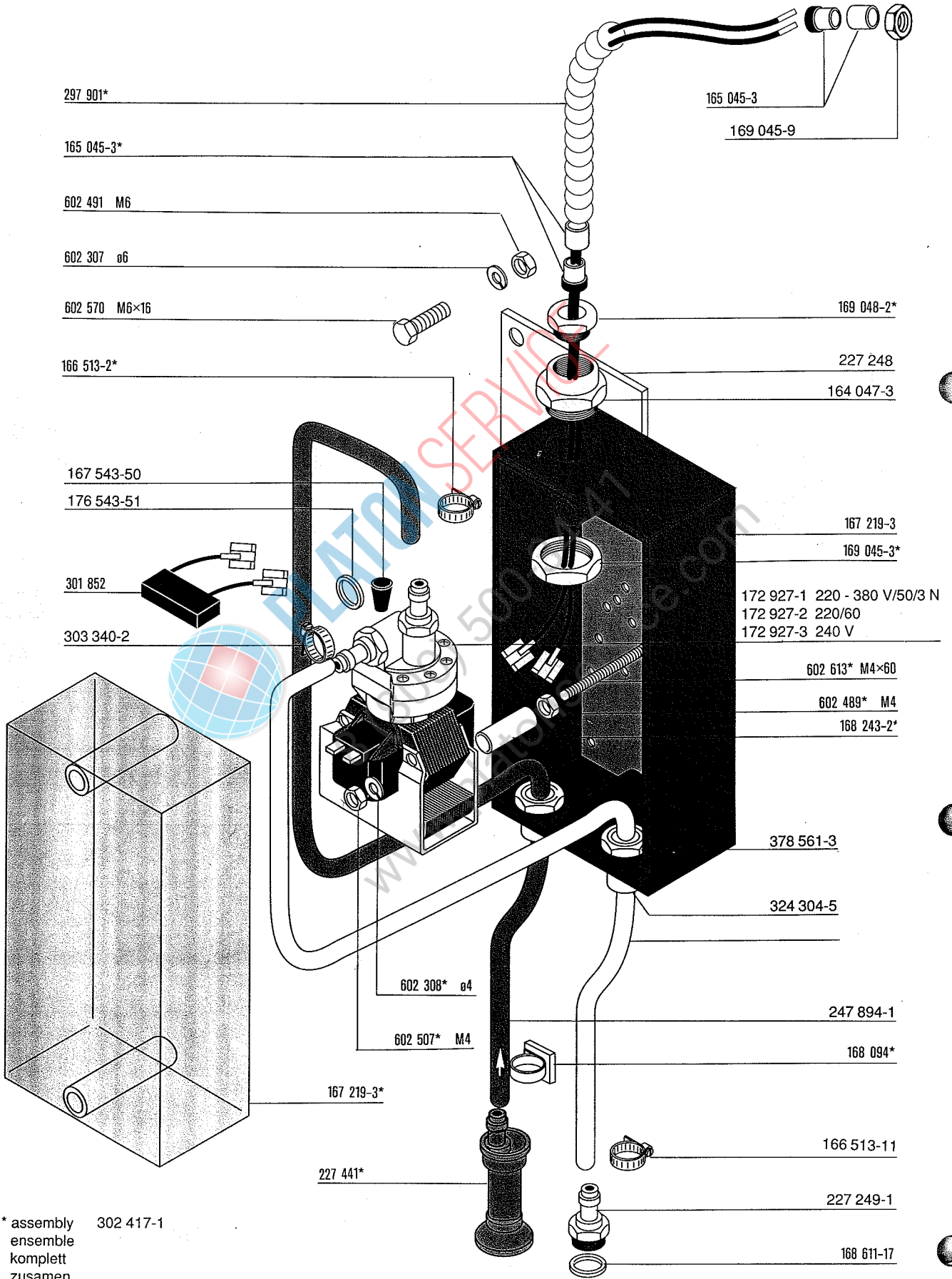

\* assembly  
 ensemble  
 komplett  
 zusammen

